

**Traffic Guidance Scheme (TGS)**  
as to AS1742.3 & TCAWS Manual V6

**Project Description: Mobile Crane Lift**  
(Refrigeration Equipment Delivery)

**TTM: Road Closure & Worksite Management**



**BROADWAY SHOPPING CENTRE (NORTH)**

North Car Park Entry/Exit

South Car Park Entry

South Car Park Exit

Leaving Dock 2 Loading Dock 2 Entry

Grose St

Broadway

City Rd

Bay St

15m Spacings

ROADWORK ON SIDE ROAD

ROADWORK ON SIDE ROAD

ROADWORK ON SIDE ROAD

ROADWORK ON SIDE ROAD

ROADWORK ON SIDE ROAD

ROADWORK ON SIDE ROAD

ROADWORK ON SIDE ROAD

ROADWORK ON SIDE ROAD

ROADWORK ON SIDE ROAD

ROADWORK ON SIDE ROAD

ROADWORK ON SIDE ROAD

ROADWORK ON SIDE ROAD

ROADWORK ON SIDE ROAD

ROADWORK ON SIDE ROAD

ROADWORK ON SIDE ROAD

ROADWORK ON SIDE ROAD

ROADWORK ON SIDE ROAD

ROADWORK ON SIDE ROAD

ROADWORK ON SIDE ROAD

ROADWORK ON SIDE ROAD

ROADWORK ON SIDE ROAD

ROADWORK ON SIDE ROAD

ROADWORK ON SIDE ROAD

ROADWORK ON SIDE ROAD

ROADWORK ON SIDE ROAD

ROADWORK ON SIDE ROAD

ROADWORK ON SIDE ROAD

ROADWORK ON SIDE ROAD

ROADWORK ON SIDE ROAD

ROADWORK ON SIDE ROAD

ROADWORK ON SIDE ROAD

ROADWORK ON SIDE ROAD



**TGS NOT TO SCALE**

SIGN SPACINGS - DIMENSION "D"	
Speed of Traffic Km/hr	Dimension D = M
45km/hr or less	15m
46km/hr - 55km/hr	15m
56km/hr - 65km/hr	45m
Greater than 65km/hr	Equal to posted Speed Limit

RECOMMENDED TAPER LENGTHS (m)			
Approximate Speed of Traffic (Km/hr)	Traffic Control at beginning of Taper	Lateral Shift	Merge Taper
45 or less	15	0	15m
46 - 55	15	15	30m
56 - 65	30	30	60m
66 - 75	N/A	70	115m
76 - 85	N/A	80	130m
86 - 95	N/A	90	145m
96 - 105	N/A	100	160m
Greater than 105	N/A	110	180m

**GENERAL NOTES:**

- > This TGS is to be read in conjunction with AS1742.3 & RMS TCAWS Manual V6.
- > TGS is for Short Term Implementation only.
- > This TGS has been prepared NOT TO SCALE from either site specific details or archived details and may not accurately reflect the exact layout of the site. Details are indicative only.
- > Work environment and site conditions may alter the correct signs and devices locations and distances stated in this plan.
- > Safe Work NSW Authorised Traffic Controllers are to be on site at all times to implement this TGS.
- > Traffic Control Team Leader must inspect the site and carry out a mandatory Risk Assessment before commencement of works. Any changes necessary must be marked on this TGS before being implemented.
- > All PPE must be worn at all times whilst on site.
- > All existing street signage that is contradictory to this worksite, must be covered prior to works.
- > All Advance Warning Signage shall comply to AS1742.3 & RMS TCAWS Manual V6.
- > All Advance Warning Signage is to be erected on the side of the road adjacent to the traffic flow.
- > Authorised Traffic Controllers are to assist with Pedestrian movements around, past or through the Work Site.
- > Removal of Traffic Control Signs and Devices is to be undertaken in the reverse order of erection, progressing away from the Work Site.

**LANE WIDTHS**

The minimum lane widths to be provided for all live traffic lanes around, past or through a Work Site shall be 3.0m - 3.5m lane widths are desirable.

**VEHICLE MOVEMENT PLAN**

All vehicles associated with these works are to enter and exit the worksite in a forward facing motion at all times, under the direction and guidance of Authorised Traffic Controllers and with the existing traffic flow conditions.

No.	Date	Name	Signature	PWZTMP No.
1				
2				
3				
4				

**50 = Posted Speed Limit**

15m Sign Spacings

**DATE:** 16th March 2023

**CLIENT:** Alliance Refrigeration

**TYPE OF WORK:** Replace Air Conditioning Units

**TC'S REQ:** 3

**UTES / TMA'S:** 1

**LGA:** City of Sydney Council

**ROAD NAME:** 52 Francis St

**LOCATION OF WORK:** Grose St

**SUBURB:** Glebe NSW 2037

**ROAD CLASS:** Local Road

**TGS DEVELOPED BY:** Phillip Blair

**APPROVED:** P. Blair

**PWZTMP LICENCE NO.:** TCT 0059241

**PLAN NO.:** RTC/23-6015

**TRANS ROL REQUIRED:** NO

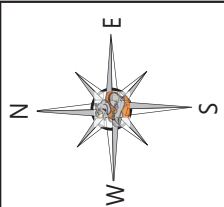

**Legend**

- North Point
- Detour Route
- Work Area
- Traffic Controller

**Traffic Guidance Scheme (TGS)**  
as to AS1742.3 & TCAWS Manual V6

**Project Description: Lifting Air Conditioning Equipment**  
**TTM: Full Road Closure - Worksite Management - Detour Route**

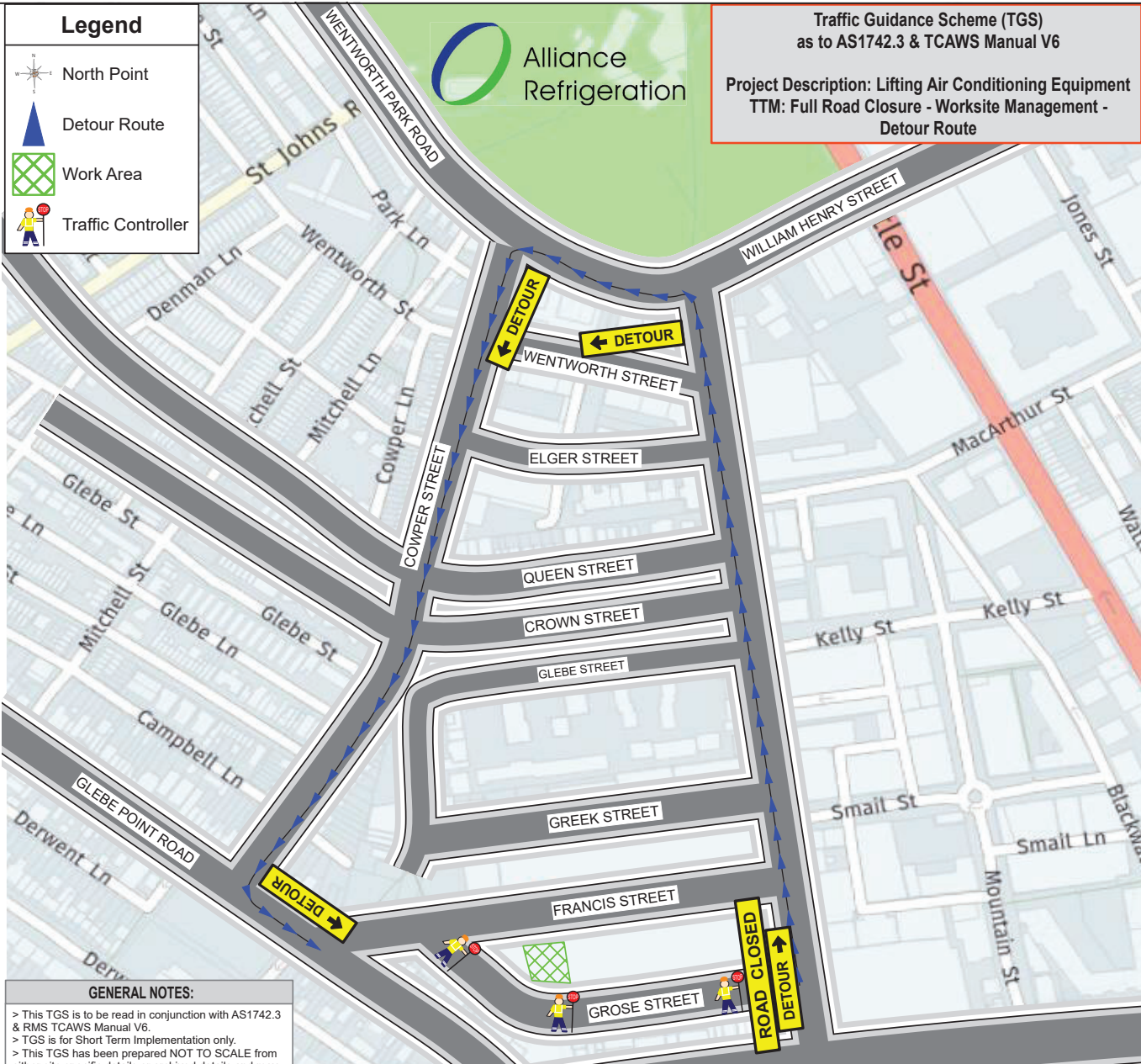

**GENERAL NOTES:**

- > This TGS is to be read in conjunction with AS1742.3 & RMS TCAWS Manual V6.
- > TGS is for Short Term Implementation only.
- > This TGS has been prepared NOT TO SCALE from either site specific details or archived details and may not accurately reflect the exact layout of the site. Details are indicative only.
- > Work environment and site conditions may alter the correct signs and devices locations and distances stated in this plan.
- > Safe Work NSW Authorised Traffic Controllers are to be on site at all times to implement this TGS.
- > Traffic Control Team Leader must inspect the site and carry out a mandatory Risk Assessment before commencement of works. Any changes necessary must be marked on this TGS before being implemented.
- > All PPE must be worn at all times whilst on site.
- > All existing street signage that is contradictory to this worksite, must be covered prior to works.
- > All Advance Warning Signage shall comply to AS1742.3 & RMS TCAWS Manual V6.
- > All Advance Warning Signage is to be erected on the side of the road adjacent to the traffic flow.
- > Authorised Traffic Controllers are to assist with Pedestrian movements around, past or through the Work Site.
- > Removal of Traffic Control Signs and Devices is to be undertaken in the reverse order of erection, progressing away from the Work Site.

**\*\*Rhino Traffic Control does not accept liability for or endorse the use of the TGS unless implemented directly by an employee of Rhino Traffic Control holding valid certifications to carry out such works\*\***

**TGS NOT TO SCALE**

**SIGN SPACINGS - DIMENSION "D"**

Speed of Traffic Km/Hr	Dimension D = M	
	AS1742.3	TCAWS
45km/hr or less	15m	15m
46km/hr - 55km/hr	15m	50m
56km/hr - 65km/hr	45m	60m
Greater than 65km/hr	Equal to posted Speed Limit	

Sign Positioning Tolerances:  
Minimum 10% less than the distance or lengths given.  
Maximum 25% more than the distance or lengths given.

**LANE WIDTHS**

The minimum lane widths to be provided for all live traffic lanes around, past or through a Work Site shall be 3.0m. 3.5m lane widths are desirable.

**VEHICLE MOVEMENT PLAN**

All vehicles associated with these works are to enter and exit the worksite in a forward facing motion at all times, under the direction and guidance of Authorised Traffic Controllers and with the existing traffic flow conditions.

**RECOMMENDED TAPER LENGTHS (m)**

Approximate Speed of Traffic (Km/Hr)	Traffic Control at beginning of Taper	Lateral Shift Taper	Merge Taper
45 or less	15	0	15m
46 - 55	15	15	30m
56 - 65	30	30	60m
66 - 75	N/A	70	115m
76 - 85	N/A	80	130m
86 - 95	N/A	90	145m
96 - 105	N/A	100	160m
Greater than 105	N/A	110	180m

Grose St: D =

**Rhino Traffic Control Services**  
Professional - Reliable - Safe  
ABN: 92 153 683 973  
PO Box 194 Kings Langley NSW 2147  
Ph: 02 8678 3737 Mob: 0452 131 325  
Email: ops@rhinotrafficcontrol.com.au

Date:	16th March 2023	LGA:	City of Sydney Council	TCP Developed By:	Phillip Blair
Client:	Alliance Refrigeration	Road Name:	52 Francis St	<b>APPROVED</b>	<i>P. Blair</i>
Type of Work:	Detour Route	Location of Work:	Grose St	PWZTMP Licence No.:	TCT 0059241
TC's Req	3	Suburb:	Glebe NSW 2037	Plan No.:	RTC/23-Site Specific
Utes / TMA's	1  0	Road Class:	Local Council Rd	RMS ROL Required:	NO

